



# MULTI-PRODUCT FOAM/SPRAY GUN OPERATING INSTRUCTIONS

**APPLICATION:** Clean and sanitize supermarket and packing house meat cutting rooms; kitchens and food preparation areas; shower rooms, restrooms or locker rooms; animals cages and runs, barns, dairy equipment, clean trucks, cars or other equipment. Use with foaming degreasers, disinfectants, general detergents, soaps, acid or caustic tile cleaners, truck washers, etc.

**SPECIFICATIONS:** Recommended water pressure - 40 to 60 psi.

**INSTRUCTIONS ASSEMBLY:** Slide plastic siphon tube (Item 10) inside sleeve under bottle cap, attach bottle to gun. Slide small end of foam wand (Item 4) or deflector (Item 3) over tube connector on outlet end of Mixing Head (Item 5).

MULTI-RATIO DIAL HAS 5 MIXING SETTINGS AND OFF					
A	B	C	D	E	Ø
1:64	1:32	1:20	1:16	1:10	OFF
2 oz./gal.	4 oz./gal.	6 oz./gal.	8 oz./gal.	12 oz./gal.	

**INSTRUCTION OPERATION:** Connect water supply hose to pistol grip shut-off valve handle (Item 6). Remove and fill bottle with liquid chemical concentrate. **CAUTION:** To

prevent chemical loss from bottle out of air vent hole in mixing head, sprayer assembly must remain in upright position at all times. Turn dial to desired mixing rate letter to siphon chemical. This will automatically mix chemical with water at the factory pre-set dilution rate selected on dial. Pistol grip shut-off valve lever must be fully depressed for accurate mixing. For a powerful clear water rinse, remove siphon head from handle and use as a water nozzle. Pull back snap ring on female quick coupler to detach or reattach mixing head to handle. For a more gentle rinse without removing mixing head, move dial to off position. **IMPORTANT NOTE:** Handle supplied with gun contains an anti-siphon device to protect water supply from accidental chemical contamination. **DO NOT USE ANY OTHER HANDLE WITH THIS SPRAYER.** If replacement is needed, a handle with anti-siphon device installed should be obtained from your supplier.

**MAINTENANCE:** After each use the gun must be cleaned to ensure trouble-free operation. Return unused chemical to original container. Rinse bottle, refill with water or the appropriate solvent, and spray for several minutes to rinse out orifice within mixing chamber. In instances where a chemical is particularly caustic or viscous, it may be necessary to soak the mixing head in water or neutralizer. This should eliminate contamination of the mixing head and build up of dried chemicals. If dried chemical builds up inside output nozzle restricting proper mixing, use a stick, pipe brush, or 1/8" hand ream to clean out nozzle and restore proper siphon action.

**REPAIR WARRANTY:** This gun is guaranteed against defects in material and workmanship for a period of one (1) year from date of purchase. The manufacturer is not responsible for guns that have been altered, incorrectly used, improperly maintained, not cleaned or abused. *Information on parts for field repair or replacement of lost parts, is available from your supplier.*

**WARNING:** Always wear eye protection that complies with current ANSI Standard Z87.1. Wear protective clothing and use a respirator when using chemicals. Spray in a well ventilated, open area. Nozzle is equipped with an anti-siphon device to prevent chemicals from being drawn back into the hose. Do not substitute nozzles. Do not spray water or solution into an electrical outlet. Severe electric shock could result. Clean sprayer and bottle thoroughly after each use to prevent contamination between different chemicals. Bottles must remain upright to prevent chemical loss out of air vent hole in the mixing head. Before using, read and understand chemical manufacturer's instructions and warnings.

**FAILURE TO HEED ALL SAFETY INSTRUCTIONS AND WARNINGS  
COULD RESULT IN PROPERTY DAMAGE, SERIOUS BODILY INJURY OR DEATH.**

Mfg. for

## Buckeye International, Inc.

2700 Wagner Place • Maryland Heights • MO 63043 • USA • (314) 291-1900

1917 (9/02)

## DESCRIPTION

## PART NUMBER

- |  |   |
|--|---|
| 1 - Anti-Siphon Unit                     | 7373  |
| 2 - Half-Gallon Bottle                   | 92520   |
| 3 - Deflector                            | 7319  |
| 4 - Foam Wand                            | 7571GM (Standard)                                 |
| 5 - Mixing Head Complete                 | 9511MRBU (Blue Caps)                              |
| 6 - Pistol Grip Shut-Off                 | 751BU (Includes Anti-Siphon Unit & Filter Washer) |
| 7 - Quick Coupler/Female with Poly Guard | 09QCFPB   |
| 8 - Quick Coupler/Male                   | 09QCM   |
| 9 - Screen & Holder                      | 36277   |
| 10 - Siphon Tube                         | 95HG24 (Half Gallon)                              |
| 11 - Washer (Head)                       | 57310   |
| 12 - Washer (Filter)                     | 6817  |
| 13 - Quick Coupler Washer                | 09QSR   |

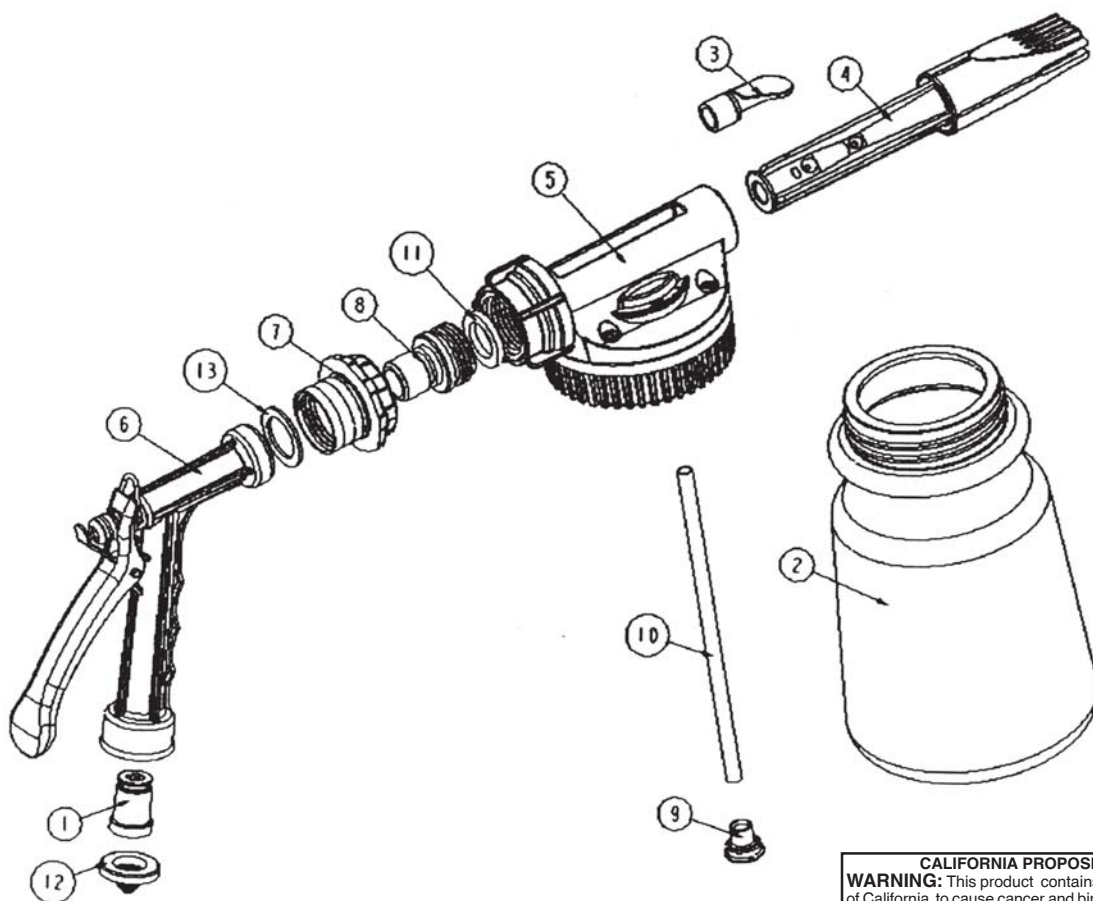

**CALIFORNIA PROPOSITION 65 WARNING**  
**WARNING:** This product contains chemicals known to the State of California to cause cancer and birth defects or other reproductive harm. (Installer: California law requires that this warning be given to the consumer.)